

# WRU

Earth leakage relay with built-in transformer



## Description

Electronic earth leakage protection relay with built-in transformer, with a diameter of 25 or 35 mm $\varnothing$ , depending on the type, creating a single set.

- Type A relay with high frequency current filtering and high immunity. Monitoring in true root mean square.
- The sensitivity can be adjusted to 0.03 ... 3 A
- The delay in the trigger can be adjusted to 0.02 ... 1 s
- LED indicator of the leak level (% sensitivity):
  - 1 flash every 2 s: between 25 and 50 %
  - 1 flash every 1 s: between 50 and 75 %
  - 1 flash every 0.5 s: between 75 and 90 %
- Adjustable to the DIN profile 46277 (EN 50022)

## Application

The WRU Series allows a reliable and immunised form of earth leakage protection, saving installation time. Its assembly is very simple, offering an adequate solution for all types of single and three-phase installations, since it offers compact earth leakage protection, with the optional adjustment of the sensitivity and time.

## Features

<b>Protection</b>	
Class	A superimmunized
Measurement	True root mean square (TRMS)
Sensitivity	0.03 ... 3 A
Delay	0.02 ... 1 s
Earth leakage transformer	Internal
Test and Reset	With built-in buttons, T & R
Remote Control (inputs)	External test
Associated circuit breaker	Contact or Circuit breaker + trigger coil
Relay signaling	<ul style="list-style-type: none"> <li>• Power supply voltage</li> <li>• Trip due to leakage</li> <li>• Pre-alarm</li> </ul>
Remote signaling (outputs)	Leak control signal (proportional alternating voltage) (only in WRU-25)
Circuit breaker control	Through an NO/NC switched relay, depending on the connection with the circuit breaker
<b>Features</b>	
Auxiliary power supply	230 Vac ( $\pm 20\%$ ) 50 / 60 Hz
Output contacts	250 Vac, 6 A
Operating temperature	-10 ... +50 °C
<b>Construction features</b>	
Fixing	DIN rail
Dimensions	4 modules (WRU-25), 6 modules (WRU-35)
Weight	228 g (WRU-25), 403 g (WRU-35)
Degree of protection	IP 20 Terminals, IP 41 back panel
<b>Standards</b>	
IEC 60947-2, IEC 60755, IEC 62020, IEC 61008	

# WRU

Earth leakage relay with built-in transformer

## Dimensions

WRU-25

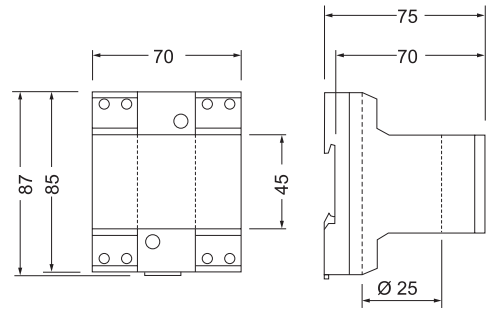

WRU-35

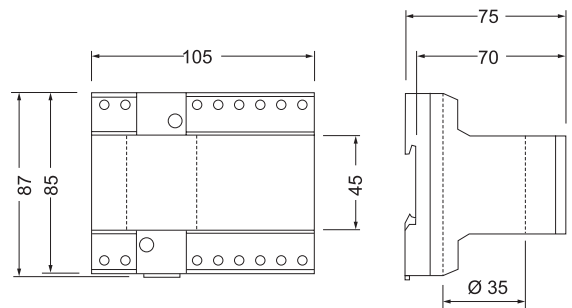

## References

Size	Useful diameter (mm)	$I_n$ (A)	Delay	Type	Code
4 modules	25	0,03 ... 3	0.02 ... 1 s	WRU-25	P14011
6 modules	35	0,03 ... 3	0.02 ... 1 s	WRU-35	P14021

The delay is cancelled in all relays with a sensitivity adjustment of 0.03 A.

## Connections

WRU-25

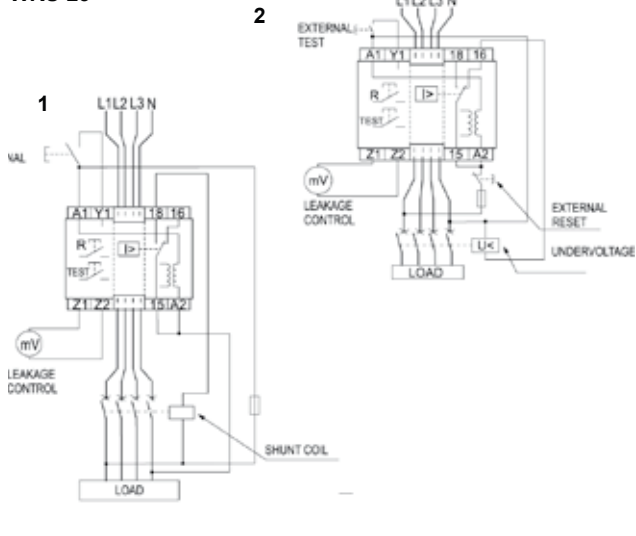

WRU-35

